



Smart ATO RO G2

Manual



Model

SATO-466V

List of Parts (Can Be Purchased Separately)

Item	Picture	Description
Smart ATO RO G2 Controller	 The image shows a black, circular Smart ATO RO G2 Controller with a digital display and two square dual sensors attached to its top.	<ol style="list-style-type: none">1. Controller with two Square Dual sensors2. Max. Mounting Thickness : 1/2 inch (12.7 mm)
Universal Power Adapter	 The image shows a black, rectangular Universal Power Adapter with a standard two-prong electrical plug and a power cord.	Input : 100-240 VAC 50-60 Hz Output : DC 12 V / 1 A
DC Solenoid Valve	 The image shows a white, rectangular DC Solenoid Valve with a blue inlet/outlet and a small control box on top.	For use with RO/DI Systems and 1/4-inch RO Tubing
Float Valve Kit	 The image shows a white, cylindrical Float Valve Kit with a black float arm and a quick connect fitting.	For additional overflow protection : <ul style="list-style-type: none">• Adjustable Float• Universal Holder• Quick Connect Fitting
1/4-inch RO Tubing 9.8 ft (300 cm)	 The image shows a coiled, white, flexible 1/4-inch RO Tubing.	For use with Float Valve Kit or RO Solenoid Valve

Controller & Square Dual Sensors

■ High Level Square Dual Sensor



■ Low Level Square Dual Sensor

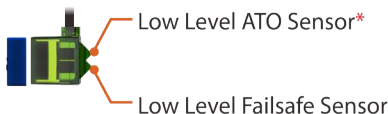

*The High Level ATO Sensor must be at least 1/4 inch (6 mm) higher than the Low Level ATO Sensor, or Smart ATO RO G2 will not work properly.

■ Smart ATO RO G2 Controller

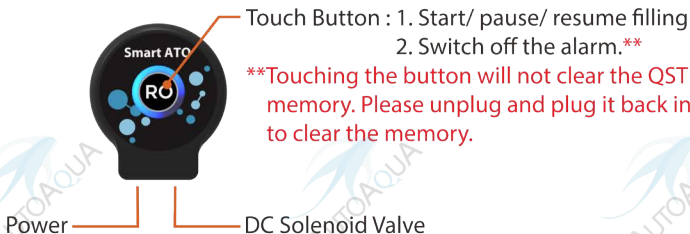

Caution : Risk of Injury from Strong Magnets

Installation

i. Float Valve Kit

- 1 Take off the nut **a** from the adjustable float.
 - 2 Put the universal holder **b** and the nut **a** through the threaded part .
- Then, screw the quick connect fitting **c** into the adjustable float.

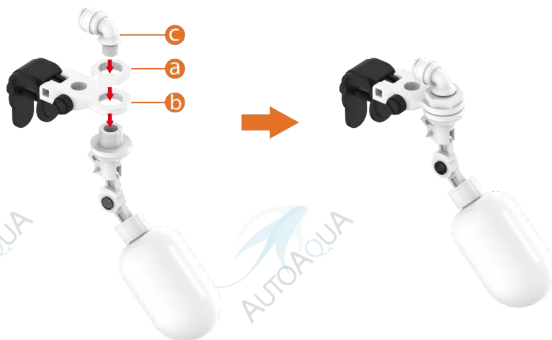

ii. Smart ATO RO G2

Step 1 :
Mount the blue sensor (S1) and adjust the lower sensor to the normal water level*.

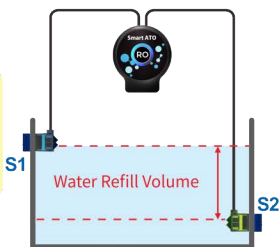

Step 2 :
Mount the green sensor (S2) and adjust the top sensor to the desired water level to refill*.

*Please set the sensor away from the direct infrared light or sun light to avoid malfunction.

a. RO/DI system without Auto Shut Off

Step 3 : Install the DC Solenoid Valve between the carbon block filter and the RO membrane.

Step 4 : Connect RO tubing to the Float Valve Kit and fix it on the reservoir.

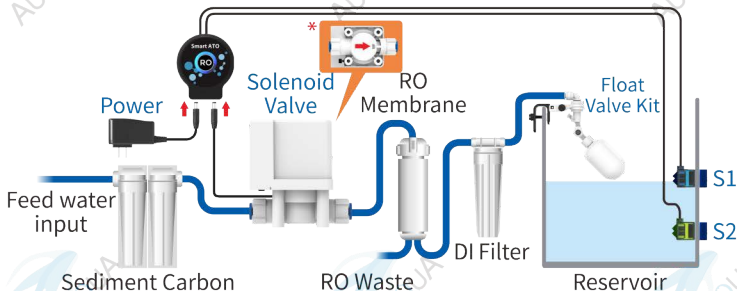

b. RO/DI system with Auto Shut Off

Step 3 : Install the DC Solenoid Valve after RO/DI system.

Step 4 : Connect RO tubing to the Float Valve Kit and fix it on the reservoir.

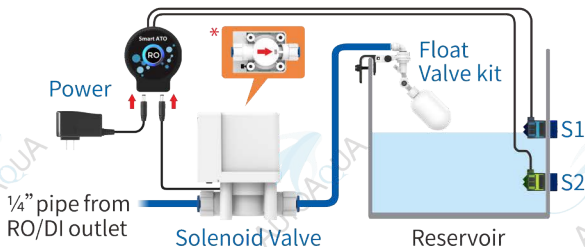

*Water flow direction on the solenoid valve must be the same as the water flow direction.

Do not install solenoid valve before filter system to avoid clogging.

LED Indicator

LED Color	Status	Description	Action
Blue	Solid	Standby Mode	N.A.
	Circling	Filling	N.A.
	Flashing every 3 sec.	Filling pauses	N.A.
	Flashing every 1 sec.	Low Level Failsafe Sensor detects no water	N.A.
	Fading with a long beep	Pump connection failure	Check the connection of the pump and the controller.
Alternating Blue & Orange*	Flashing with short beeps	QST alarm: abnormal filling time	Check if the RO/DI system works properly.
Orange	Flashing every 1 sec.**	High Level Failsafe Sensor detects water	N.A.
	Solid with long beeps	Power Overvoltage Detection	Check the power adaptor output is 12V, rather than 24V.

*Please unplug the power cord and plug it back in to clear QST memory.

**For small reservoirs, the High Level Failsafe Sensor may be triggered after each refilling. This is normal and no action is required.

Operation

1. When Smart ATO RO G2 is powered up, the LED indicator will fade up blue and orange.
2. Smart ATO RO G2 will perform a one-time filling automatically after every power-up if the low level ATO sensor detects no water. If it detects water after power-up, it will turn to standby mode.
3. Touching the button can start or pause filling manually.

Quick Security Technology (QST)

Smart ATO RO G2 uses QST for real-time protection against any failure situation. The controller will give an audible and visual alert when it senses any other refilling time is 6 times longer than the first filling time.*

QST can detect the malfunction of the sensor or the solenoid valve. For example, if the first filling time is 10 sec., it will alert when any other refilling time is over 60 sec.

***Note : No security time control for the first filling.**

Specifications

1. Power Input : 100-240 VAC 50-60 Hz
2. DC Solenoid Valve :
 - Power : 6 W@12 VDC
 - Pressure : 0.02-0.7 MPA
 - Cable Length : 120 cm (4 ft)
 - Connector : DC 5.5 x 2.5 mm Male
 - 1/4 inch RO Tubing Connection
3. Max. Mounting Thickness :
 - Sensor : 1/2 inch (12.7 mm)
 - Universal Holder : 3/4 inch (19 mm)

Limited Warranty

Notice: Read the entire Limited Warranty prior to purchasing, installing or using this product. By purchasing, installing or using this product, you are acknowledging that this Limited Warranty is part of the sale terms.

AUTOAQUA products are warranted to be free from defects in defects and workmanship for one year from the date of original purchase from an authorized reseller to the original purchaser. This Limited Warranty is not transferable.

AUTOAQUA is not responsible for, and the Limited Warranty does not cover the following: product failures or damage due to normal wear and tear, damages caused by heat/moisture/neglect/improper installation/misuse/abuse/modifications/corrosive chemicals.

Limitation of Liability – this Limited Warranty covers only the repair or replacement of the product when damage or failure is a direct result of a defect of the materials or workmanship. In no event will AUTOAQUA be liable to you or any other party for any direct, indirect, incidental, consequential or other damages arising out of the use of the product. AUTOAQUA does not cover personal injury, personal loss, or other damages associated with the use of the products. In no case will AUTOAQUA's liability exceed the amount you paid for the product. If you disagree with these terms and conditions, do not use the covered products.

All warranty repairs or replacements are performed by the authorized distributor in the region where the Product was first shipped by AUTOAQUA. To request warranty service, please email us through our website, www.autoaqua.com.tw or service@autoaqua.com.tw. You will receive instructions on how to return the Product for repair or replacement. A copy of the original purchase receipt will be required and buyer shall be responsible for shipment and insurance costs to send the Product to AUTOAQUA for warranty service. International and/or expedited shipping are not covered under your AUTOAQUA warranty.

Purchase Date

(Y/M/D)

Warranty Period

One year from the purchase date

Place of Purchase

(Store name, phone, email, address)

Service

AUTOAQUA Technologies Co., Ltd.
7F-7.,NO.229,Fuxing 2nd Rd.,Zhubei
City, Hsinchu County,Taiwan
E-mail : service@autoaqua.com.tw
www.autoaqua.com.tw

* Please go to AUTOAQUA website to get the distributor information.

